



2265 Crosswind Drive • Prescott, AZ 86301  
(928) 636-3175

# DODGE T300 1500 & 2500 4WD FRONT DUAL SHOCK SYSTEM INSTALLATION INSTRUCTIONS KIT # DS39

### ⚠ WARNING

This kit should only be installed on a vehicle that is in good working condition. Before you install the kit, thoroughly inspect the vehicle for corrosion or deformation of the sheet metal around the factory body mounts. If the vehicle is suspected to have been in a collision or misused, do not install this kit. Off-road use of your vehicle with this kit installed may increase the stress applied to the factory body mounts. We do not recommend that any vehicle with a body lift kit installed be involved in any extreme off-road maneuvers such as jumping. Failure to observe this warning may result in serious personal injury and/or severe damage to your vehicle.

### ⚠ WARNING

Read and understand all instructions, warnings and safety precautions in these instructions and your owners manual before attempting to install these components.

### PRODUCT SAFETY WARNING

Certain Performance Automotive Group products are intended to improve off-road performance. Modifying your vehicle for off-road use may result in the vehicle handling differently than a factory equipped vehicle. Use of oversized tires, suspension lifts, body lifts and other suspension modifications may raise your vehicle's center of gravity resulting in an increased tendency for the vehicle to pitch and roll during sudden turns or abrupt maneuvers. Extreme care must be used to prevent loss of control or vehicle roll over. Failure to drive your modified vehicle safely may result in serious injury or death. Drive at reduced speeds to ensure your ability to maintain control of the vehicle under all driving conditions. Always wear seat belts.

### ⚠ CAUTION

Proper installation of Performance Automotive Group products requires knowledge of recommended procedures for disassembly/assembly of OE vehicles and components. Access to OE shop manuals and special tools are required. Attempting to install this kit without knowledge of these procedures may affect the safety of your vehicle and/or the performance of these components. Performance Automotive Group strongly recommends that this kit be installed by a certified mechanic with off-road experience.

## Before Starting Installation

1. Carefully read all warnings and instructions completely before beginning.
2. Verify all parts have been received in this kit by checking the parts list at the end of this document
3. **Only install this kit on the vehicle for which it is specified.** If anytime during the installation you encounter something different from what is outlined in the instructions, call technical support at (928) 636-3175.

### ⚠ CAUTION

Performance Automotive Group recommends the use of Loctite® on all hardware, unless noted otherwise.

### ⚠ WARNING

Properly block and secure vehicle prior to installation.

# Dual Shock Installation

1. Prepare vehicle for shock installation.
  - a. Loosen front lug nuts but do not remove.
  - b. Raise the vehicle with a hydraulic jack or equivalent.
  - c. Support frame with jack stands.
  - d. Remove front wheels.
2. **Stock or 2" lifted vehicles:** Install *kit lower shock bracket (940913)* on driver's side.
  - a. Remove nut from upper suspension arm pivot bolt.
  - b. Install *kit lower shock bracket (940913)* onto pivot bolt.
  - c. Install OEM nut removed previously. Do not tighten at this time.
  - d. Align bottom hole in *kit bracket* with lower hold in OE axle bracket.
  - e. Install *kit 1/2" x 1-1/2" bolt, washer and lock nut*. Torque to 75 Ft. Lbs.
  - f. Torque OE pivot bolt to factory specifications.

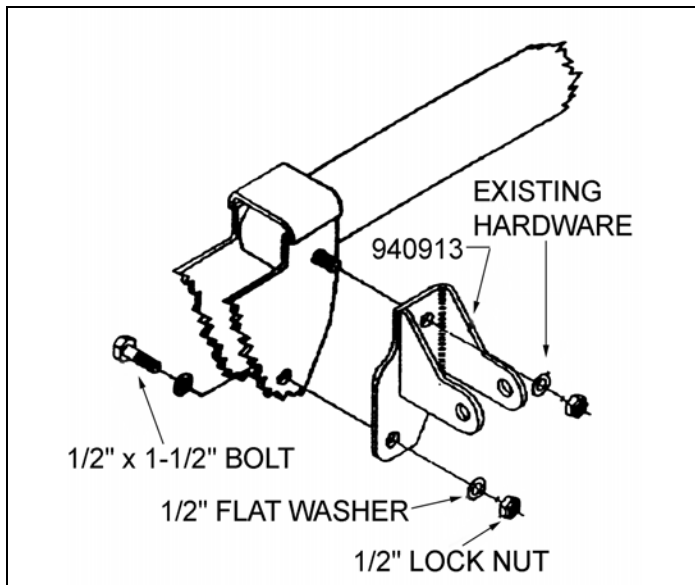

3. **4" lifted vehicles:** Install *kit lower shock bracket (940913)* on driver's side.
  - a. Remove nut from lower outside bolt retaining upper suspension arm relocation bracket to the axle.
  - b. Remove nut from bolt at original upper suspension arm pivot point.
  - c. Install *kit lower shock bracket (940913)* onto existing bolts.
  - d. Secure *kit bracket* with existing hardware.
  - e. Torque bolts to 75 Ft. Lbs.

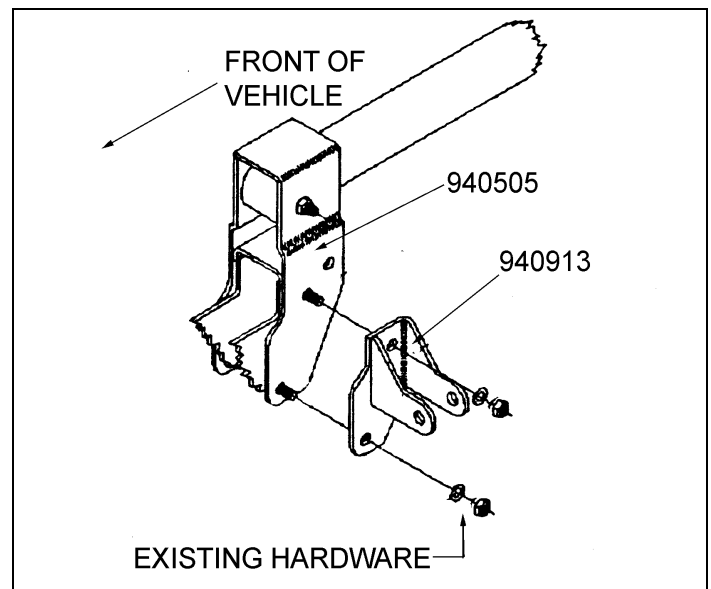

4. Install *kit upper shock mount*.
  - a. Support front axle.
  - b. Disconnect upper OE shock mount.
  - c. Remove nut, retainer, and bushing from current shock stem.
  - d. Remove three nuts retaining OE upper shock mount.
  - e. Place *kit upper shock mount ring (941003)* over existing studs (or bolts if your truck has a 2" lift).

- f. Install OE shock bracket over **kit bracket** effectively “sandwiching” the **kit bracket**.
- g. Install nuts and torque to OE specifications. (30 Ft. Lbs. if your truck has 2” lift)

- a. Install shock into upper mount using **kit 1/2” x 3” bolt, washer and lock nut**.

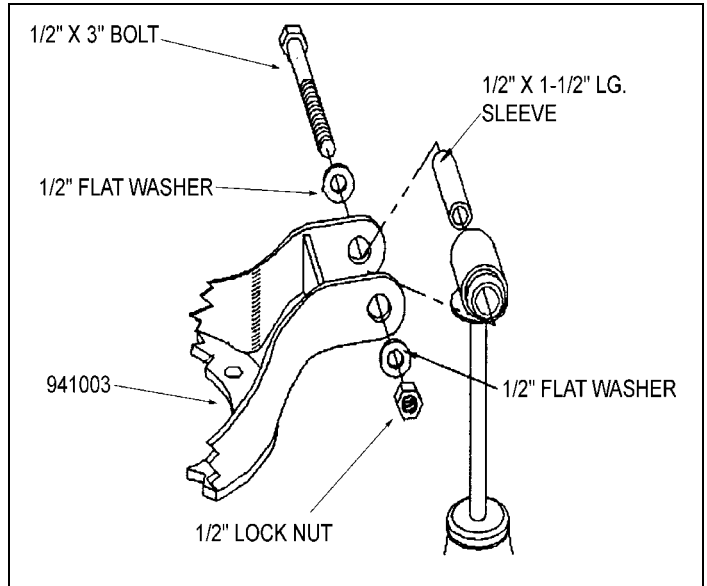

- b. Install shock into lower mount using **kit 1/2” x 3” bolt, washer and lock nut**.

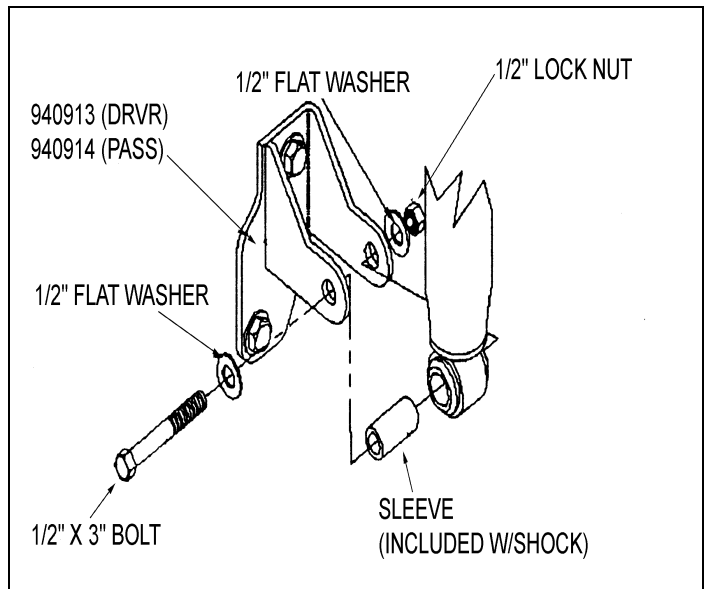

- c. Torque upper and lower shock bolts to 75 Ft. Lbs.

- 7. Repeat previous steps on opposite side of vehicle.
- 8. Reinstall wheels.
- 9. Lower vehicle.
  - a. Raise vehicle with floor jack and remove jack stands.

**△NOTE**  
 On vehicles with 2” suspension system it may be necessary to disengage or remove the coil spring to gain access to the heads of the frame extension bolts.

- 5. Install OE Shock Absorber
  - a. With retainer and bushing still on the lower portion of the shock stem, pull the stem through the hole in the OE shock tower.
  - b. Place bushing and retainer previously removed onto shock stem.
  - c. Install nut onto stem and tighten until bushing is slightly compressed.

- 6. Install recommended shock absorbers.

**△NOTE**  
 The use of shock absorbers other than those recommended by Trail Master may cause serious damage to OE and related components, and will void your Trail Master warranty.

**△NOTE**  
 When using the shocks required for 2” lifted vehicles it will be necessary to remove the steel sleeves in the upper mount of the shock. Install the sleeves that are supplied with the DS39 kit.

b. Slowly lower vehicle.

10. Torque wheels to factory specifications.

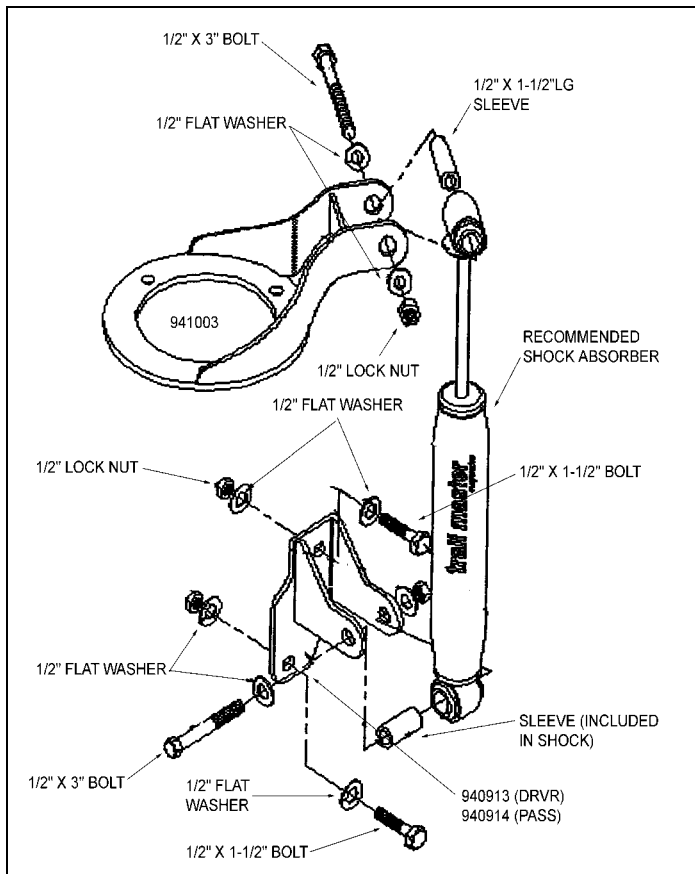

## PARTS LIST

### Qty Description

- 1 DRVR Side Axle Bracket (940913)
- 1 PASS Side Axle Bracket (940914)
- 2 Upper Shock Mount (941003)

### Bag Kit:

- 4 Bolt, 1/2" x 3"
- 2 Bolt, 1/2" x 1-1/2"
- 12 Washer, 1/2" Flat
- 6 Nut, 1/2" Locking
- 2 Sleeve, 1/2"ID x 1-5/8"lg.

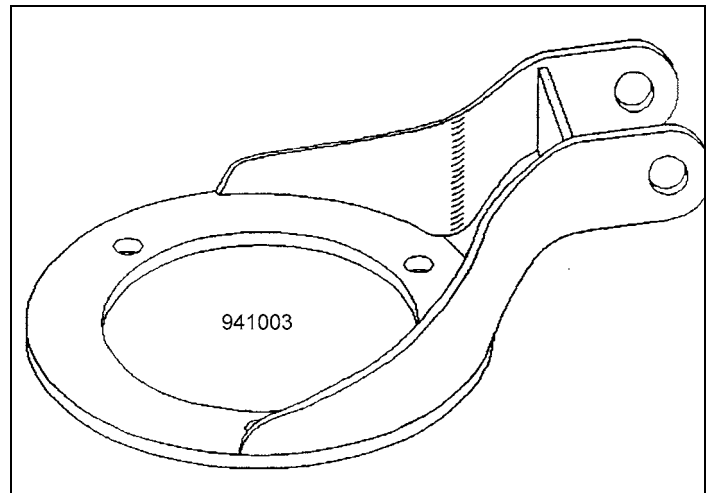

## POST-INSTALLATION NOTES

### ⚠ CAUTION

Retorque all fasteners after 500 miles and after off road use.

1. Retain this and all information regarding your altered vehicle for future reference. Thank you for choosing Trail Master Suspension. For questions or suggestions, contact our Technical Assistance Department at (928) 636-3175.

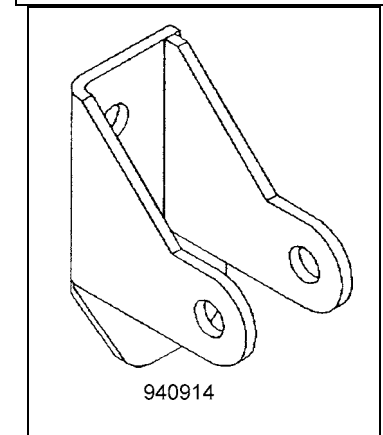
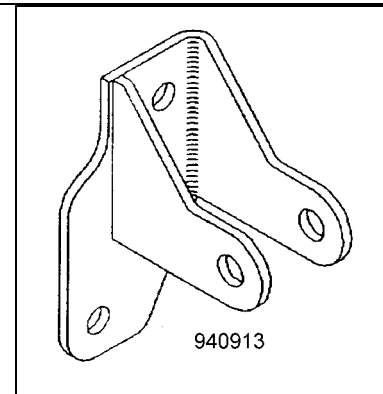

**Recommended Shock Absorbers:**

- 2 Trail Master Shocks (4") P/N-62680
- 2 Trail Master Shocks (2") P/N-62470

**Torque Specifications**

See factory service manual for torque values when re-using OE fasteners.

<b><u>Bolt Size</u></b>	<b><u>Grade 5 (ft.-lbs.)</u></b>	<b><u>Grade 8 (ft.-lbs.)</u></b>
1/4"-20	10	10
1/4"-28	10	12.5
5/16"-18	17	22.5
5/16"-24	20	25
3/8"-16	30	40
3/8"-24	35	45
7/16"-14	50	65
7/16"-20	55	70
1/2"-13	75	100
1/2"-20	55	70
9/16"-12	105	135
9/16"-18	115	150
5/8"-11	150	195
5/8"-18	160	210
3/4"-16	175	225

Rev. 01, Copyright 4/05  
Performance Automotive Group